

### Floating and Proportional Control

The RA-3000 series synchronous motor-driven reversible actuators are available for 3-point (floating) or with electric positioner for 0...10 V control.

They feature factory calibrated pressure switches to provide specified close-off ratings. These actuators are available in three sizes with 1600 N, 1800 N and with 3000 N nominal force and can be used with JC flanged valves according to maximum close-off pressure ratings specified.

Factory fitted options, such as 2kOhm feedback potentiometer, auxiliary switches and hand crank are available.

#### Features

- Uses synchronous motor with pressure switches
- Special clamp coupler quick-fit systems
- Models for 3-point and proportional 0...10 VDC control
- Positioner with adjustable starting point, span, and direct/reverse action
- Active 0...10 VDC position feedback on proportional models
- Optional auxiliary switches and feedback potentiometer available
- Optional hand crank

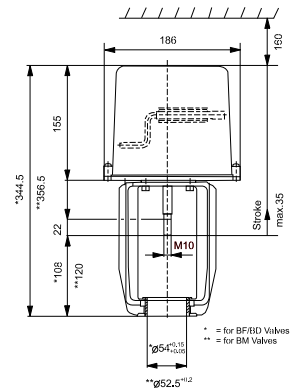

Dimensions in mm

	RA-3xxx-712x	RA-3xxx-722x	RA-3xxx-732x
H1	58 mm	66 mm	66 mm

Ordering Codes*	Hand Crank**	Actuator Force	Supply Voltage	Nominal Stroke	Protection Class
RA-30xx-7126	---	1600 N	24 V, 50/60 Hz	13 mm	IP 54
RA-31xx-7126	■				
RA-30xx-7127	---		230 V, 50/60 Hz		
RA-31xx-7127	■				
RA-30xx-7226	---	1800 N	24 V, 50/60 Hz	25 mm	
RA-31xx-7226	■				
RA-30xx-7227	---		230 V, 50/60 Hz		
RA-31xx-7227	■				
RA-30xx-7325	---	3000 N	24 V, 60 Hz	42 mm	
RA-31xx-7325	■				
RA-30xx-7326	---		24 V, 50 Hz		
RA-31xx-7326	■				
RA-30xx-7327	---		230 V, 50 Hz		
RA-31xx-7327	■				
RA-30xx-7328	---		230 V, 60 Hz		
RA-31xx-7328	■				

#### Notes

- \* : xx = 100 None  
 03 2 auxiliary switches and 2 KΩ feedback potentiometer  
 41 Built-in positioner 0...10 VDC and 2 auxiliary switches (only 24 VAC models)